



Mallard Pass

Solar Farm

Mallard Pass Solar Farm

Traffic Regulation Measures Plans - Temporary Measures

Deadline 5 - September 2023

PINS Ref: EN010127

Document Ref: EN010127/APP/2.7.2

Revision P2

Infrastructure Planning (Applications: Prescribed Forms and Procedure) Regulations
2009 - Reg 5 (2) (o)

X:\LDA_4990\2002_MALLARD PASS SOLAR FARM\CAD\1.0_CURRENT\1.0.1_SHEETS\PROWS\4990-2001-T-067-078 + 090-091-P2 - TRAFFIC REGULATION MEASURES PLANS - TEMPORARY ROAD CLOSURES.DWG

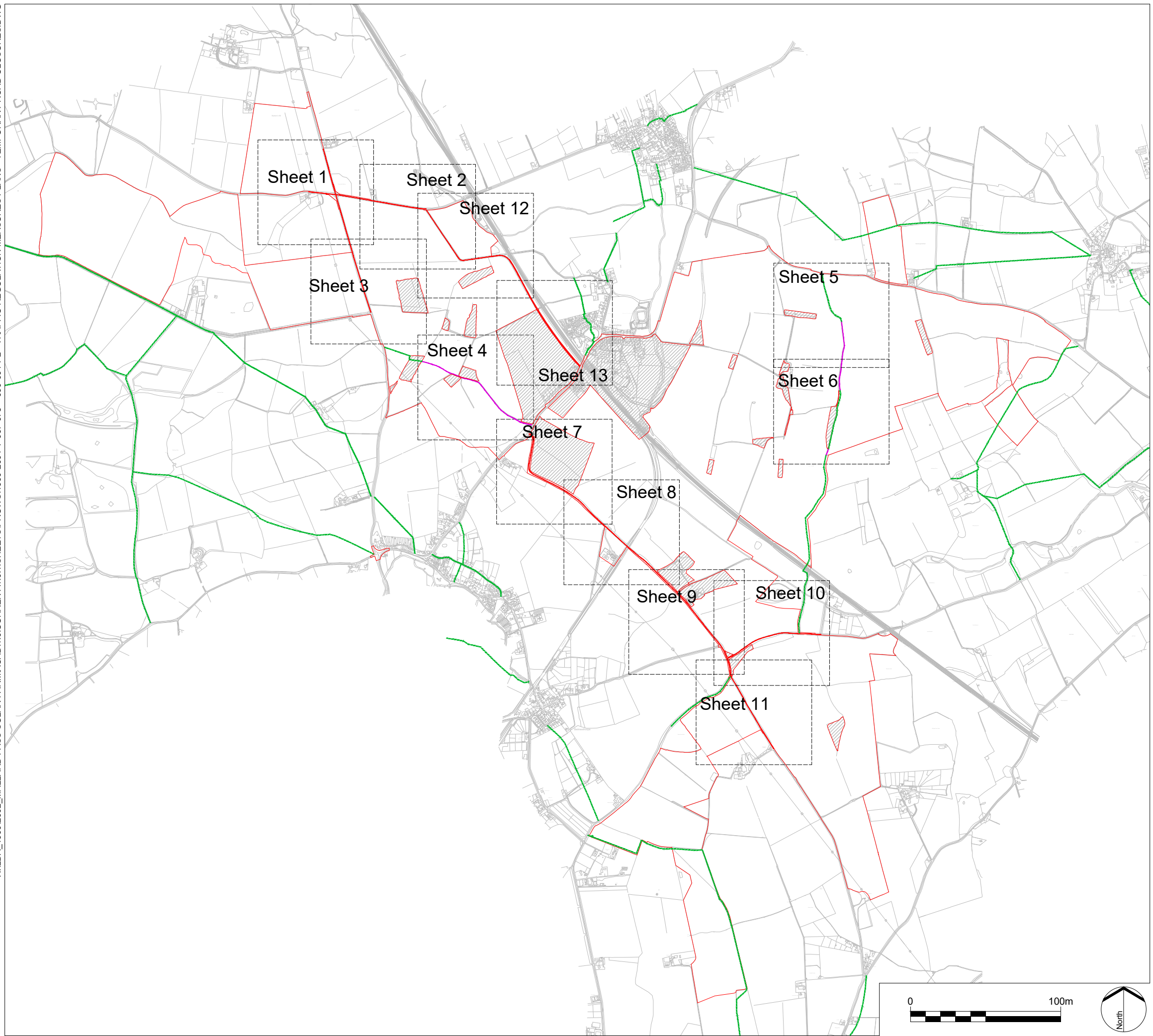

LEGEND

KEY PLAN:

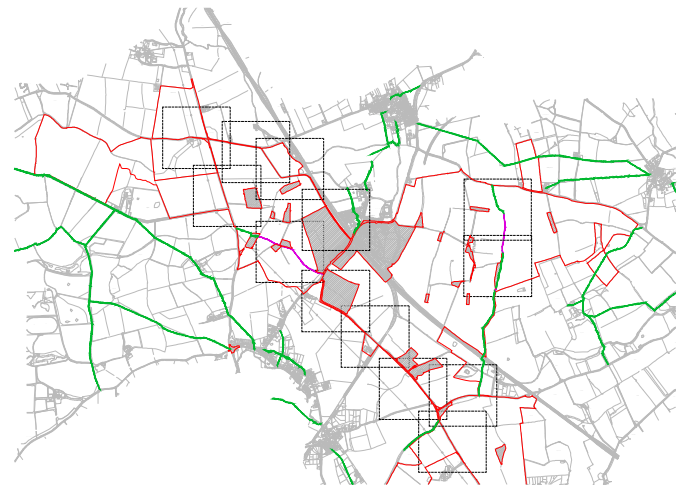

- Order limits
- Areas outside of Order limits
- Proposed Temporary Road Closures
- Proposed Temporary Road Closures (Public Right of Way)
- Existing public right of way

- NOTES:
1. The Traffic Regulation Measures Plans should be read in conjunction with the Development Consent Order and the documents to be certified under it, in particular article 15, and Schedule 8 of the Development Consent Order.
 2. Information relating to the Public Rights of Way and accesses can be found on the rights of way and access plans.
 3. The Order limits has been drawn to the Land Registry boundaries and topographical survey data of the site. The accuracy of land registry and the topographical survey differs from the OS base mapping which results in the order limits not aligning with the line work shown on the OS Mapping.
 4. Further information on the Public Rights of Way can be found on Figure 6.5 of the Environmental Statement.

REV.	DESCRIPTION	APP. DATE
P2	Addition of Temporary Road Closure	RP 14/08/23
P1	Addition of existing PRoW	RP 18/01/23
P0	Submission	RP 18/11/22



PROJECT TITLE
MALLARD PASS SOLAR FARM

DRAWING TITLE
TRAFFIC REGULATION MEASURES PLANS - TEMPORARY ROAD CLOSURES - KEY PLAN
Infrastructure Planning (Applications: Prescribed Forms and Procedure) Regulations 2009
APFP Regulation: 5(2)(o)

PINS REFERENCE NO
EN010127

ISSUED BY	Oxford	T: 01865 887 050
DATE	18 NOV 2022	DRAWN GSF
SCALE@A3	1:2,500	CHECKED CR
STATUS	Planning	APPROVED RP

DWG. NO 4990-2001-T-067 REV :P2

No dimensions are to be scaled from this drawing.
All dimensions are to be checked on site.
Area measurements for indicative purposes only.

© LDA Design Consulting Ltd. Quality Assured to BS EN ISO 9001 : 2015
Sources Ordnance Survey

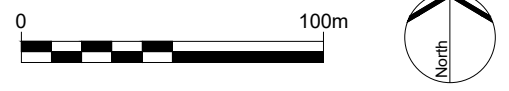

X:\LDA_4990\2002_MALLARD PASS SOLAR FARM\CAD\1.0 CURRENT\1.0.1 SHEETS\PROWS\4990-2001-T-067-078 + 090-091-P2 - TRAFFIC REGULATION MEASURES PLANS - TEMPORARY ROAD CLOSURES.DWG

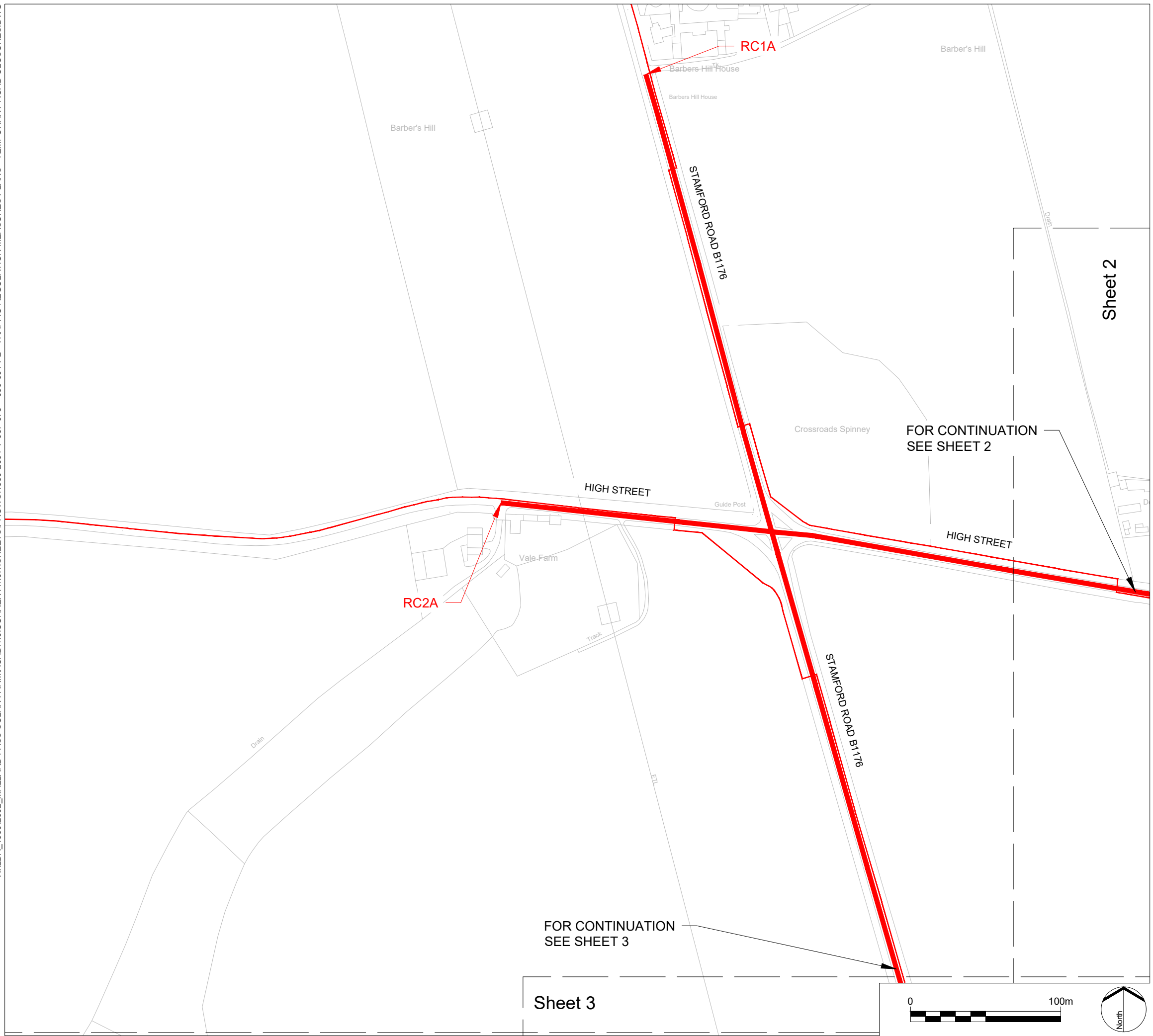

LEGEND

KEY PLAN:

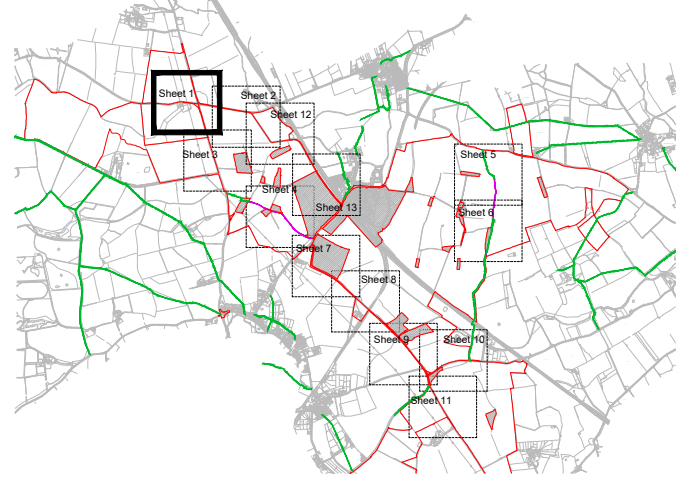

- Order limits
- Areas outside of Order limits
- Proposed Temporary Road Closures
- Proposed Temporary Road Closures (Public Right of Way)
- Existing public right of way

- NOTES:
1. The Traffic Regulation Measures Plans should be read in conjunction with the Development Consent Order and the documents to be certified under it, in particular article 15, and Schedule 6 of the Development Consent Order.
 2. Information relating to the Public Rights of Way and accesses can be found on the rights of way and access plans.
 3. The Order limits has been drawn to the Land Registry boundaries and topographical survey data of the site. The accuracy of land registry and the topographical survey differs from the OS base mapping which results in the order limits not aligning with the line work shown on the OS Mapping.
 4. Further information on the Public Rights of Way can be found on Figure 6.5 of the Environmental Statement.

REV.	DESCRIPTION	APP. DATE
P2	Addition of Temporary Road Closure	RP 14/08/23
P1	Addition of existing PRoW	RP 18/01/23
P0	Submission	RP 18/11/22



PROJECT TITLE
MALLARD PASS SOLAR FARM

DRAWING TITLE
TRAFFIC REGULATION MEASURES PLANS - TEMPORARY ROAD CLOSURES - SHEET 1 OF 13
 Infrastructure Planning (Applications: Prescribed Forms and Procedure) Regulations 2009
 APFP Regulation: 5(2)(o)

PINS REFERENCE NO
EN010127

ISSUED BY	Oxford	T: 01865 887 050
DATE	18 NOV 2022	DRAWN GSF
SCALE@A3	1:2,500	CHECKED CR
STATUS	Planning	APPROVED RP

DWG. NO 4990-2001-T-068 REV :P2

No dimensions are to be scaled from this drawing.
 All dimensions are to be checked on site.
 Area measurements for indicative purposes only.

© LDA Design Consulting Ltd. Quality Assured to BS EN ISO 9001 : 2015
 Sources Ordnance Survey

X:\LDA_4990\2002_MALLARD PASS SOLAR FARM\CAD\1.0_CURRENT\1.0.1_SHEETS\PROWS\4990-2001-T-067-078 + 090-091-P2 - TRAFFIC REGULATION MEASURES PLANS - TEMPORARY ROAD CLOSURES.DWG

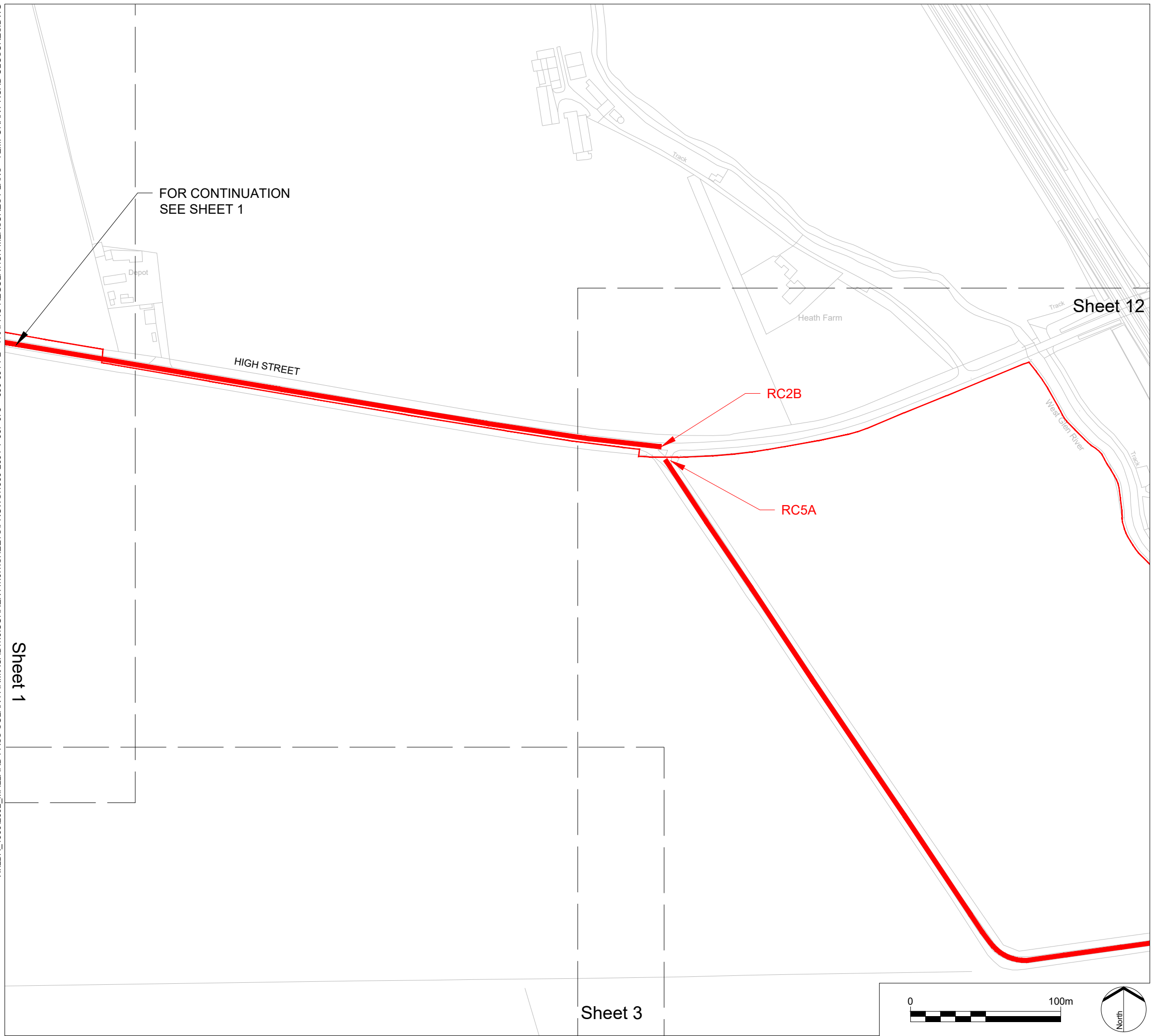

FOR CONTINUATION
SEE SHEET 1

Sheet 1

Sheet 12

Sheet 3

LEGEND

KEY PLAN:



- Order limits
- Areas outside of Order limits
- Proposed Temporary Road Closures
- Proposed Temporary Road Closures (Public Right of Way)
- Existing public right of way

- NOTES:
- The Traffic Regulation Measures Plans should be read in conjunction with the Development Consent Order and the documents to be certified under it, in particular article 15, and Schedule 6 of the Development Consent Order.
 - Information relating to the Public Rights of Way and accesses can be found on the rights of way and access plans.
 - The Order limits has been drawn to the Land Registry boundaries and topographical survey data of the site. The accuracy of land registry and the topographical survey differs from the OS base mapping which results in the order limits not aligning with the line work shown on the OS Mapping.
 - Further information on the Public Rights of Way can be found on Figure 6.5 of the Environmental Statement.

REV.	DESCRIPTION	APP. DATE
P2	Addition of Temporary Road Closure	RP 14/08/23
P1	Addition of existing PRoW	RP 18/01/23
P0	Submission	RP 18/11/22



PROJECT TITLE
MALLARD PASS SOLAR FARM

DRAWING TITLE
**TRAFFIC REGULATION MEASURES PLANS
- TEMPORARY ROAD CLOSURES -
SHEET 2 OF 13**
Infrastructure Planning (Applications: Prescribed
Forms and Procedure) Regulations 2009
APFP Regulation: 5(2)(o)

PINS REFERENCE NO
EN010127

ISSUED BY	Oxford	T: 01865 887 050
DATE	18 NOV 2022	DRAWN GSF
SCALE@A3	1:2,500	CHECKED CR
STATUS	Planning	APPROVED RP

DWG. NO 4990-2001-T-069 REV :P2

No dimensions are to be scaled from this drawing.
All dimensions are to be checked on site.
Area measurements for indicative purposes only.

© LDA Design Consulting Ltd. Quality Assured to BS EN ISO 9001 : 2015

Sources Ordnance Survey

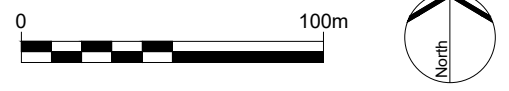

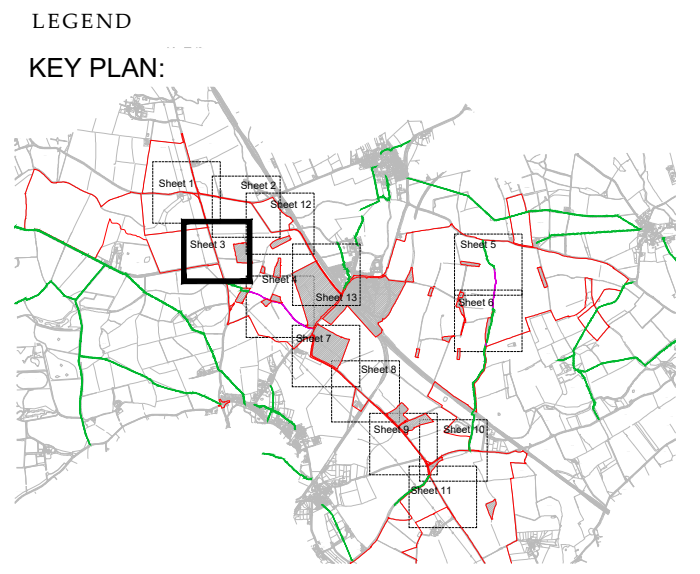
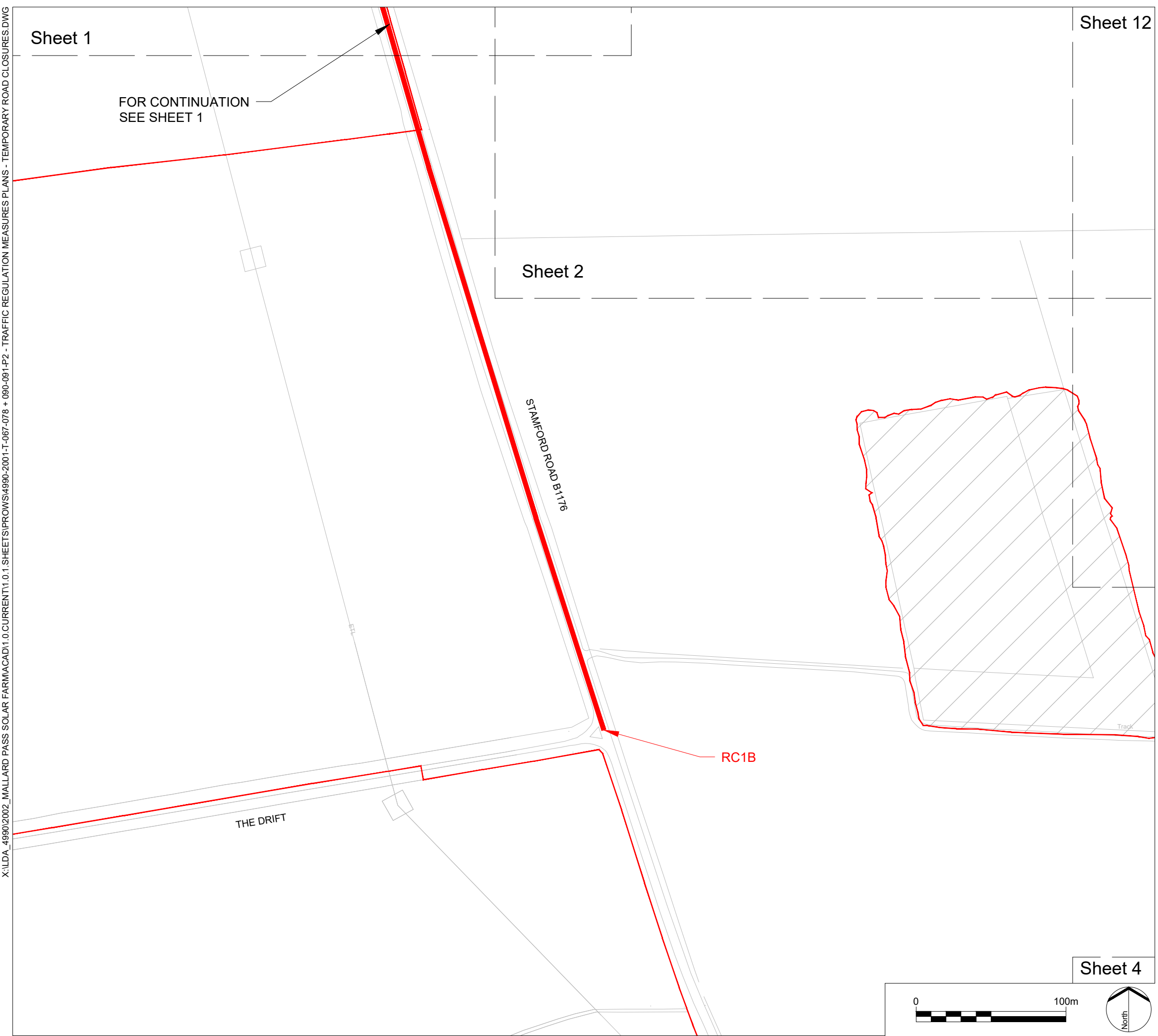

- LEGEND**
- Order limits
 - Areas outside of Order limits
 - Proposed Temporary Road Closures
 - Proposed Temporary Road Closures (Public Right of Way)
 - Existing public right of way

NOTES:

1. The Traffic Regulation Measures Plans should be read in conjunction with the Development Consent Order and the documents to be certified under it, in particular article 15, and Schedule 6 of the Development Consent Order.
2. Information relating to the Public Rights of Way and accesses can be found on the rights of way and access plans.
3. The Order limits has been drawn to the Land Registry boundaries and topographical survey data of the site. The accuracy of land registry and the topographical survey differs from the OS base mapping which results in the order limits not aligning with the line work shown on the OS Mapping.
4. Further information on the Public Rights of Way can be found on Figure 6.5 of the Environmental Statement.

P2	Addition of Temporary Road Closure	RP	14/08/23
P1	Addition of existing PRoW	RP	18/01/23
P0	Submission	RP	18/11/22
REV.	DESCRIPTION	APP.	DATE



PROJECT TITLE
MALLARD PASS SOLAR FARM

DRAWING TITLE
TRAFFIC REGULATION MEASURES PLANS
- TEMPORARY ROAD CLOSURES -
SHEET 3 OF 13
Infrastructure Planning (Applications: Prescribed
Forms and Procedure) Regulations 2009
APFP Regulation: 5(2)(o)

PINS REFERENCE NO
EN010127

ISSUED BY	Oxford	T:	01865 887 050
DATE	18 NOV 2022	DRAWN	GSF
SCALE@A3	1:2,500	CHECKED	CR
STATUS	Planning	APPROVED	RP

DWG. NO 4990-2001-T-070 **REV :P2**

No dimensions are to be scaled from this drawing.
All dimensions are to be checked on site.
Area measurements for indicative purposes only.

© LDA Design Consulting Ltd. Quality Assured to BS EN ISO 9001 : 2015
Sources Ordnance Survey

X:\LDA_4990\2002_MALLARD PASS SOLAR FARM\CAD\1.0 CURRENT\1.0.1 SHEETS\PROWS\4990-2001-T-067-078 + 090-091-P2 - TRAFFIC REGULATION MEASURES PLANS - TEMPORARY ROAD CLOSURES.DWG

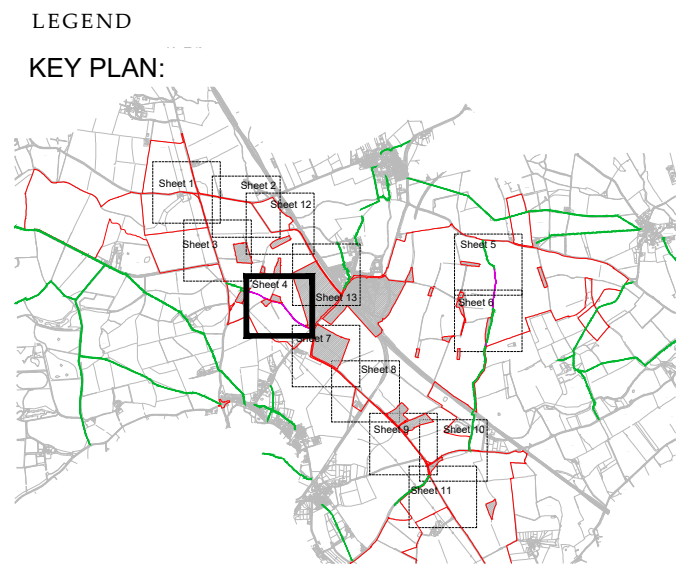
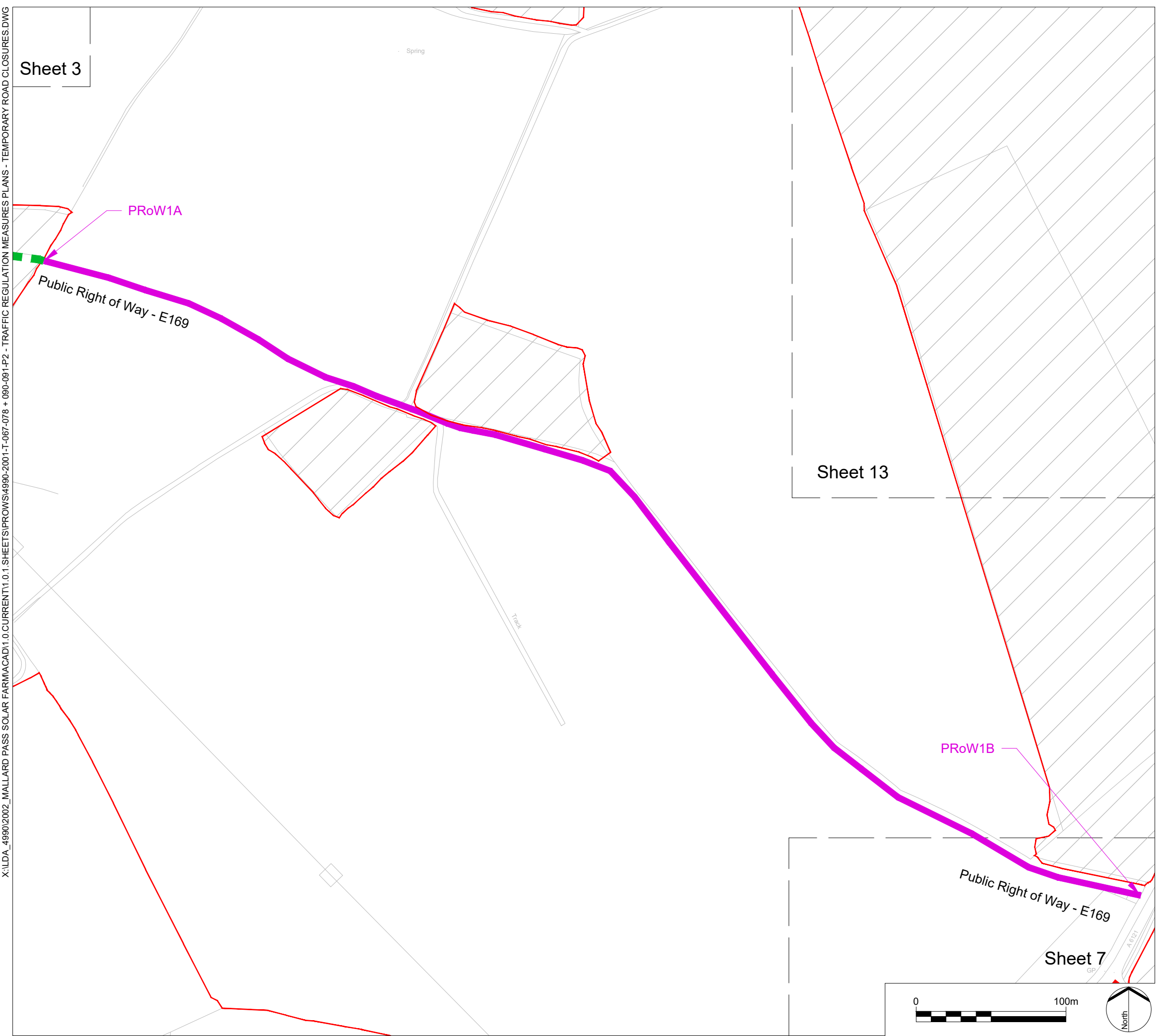

- LEGEND**
- Order limits
 - Areas outside of Order limits
 - Proposed Temporary Road Closures
 - Proposed Temporary Road Closures (Public Right of Way)
 - Existing public right of way

- NOTES:**
1. The Traffic Regulation Measures Plans should be read in conjunction with the Development Consent Order and the documents to be certified under it, in particular article 15, and Schedule 9 of the Development Consent Order.
 2. Information relating to the Public Rights of Way and accesses can be found on the rights of way and access plans.
 3. The Order limits has been drawn to the Land Registry boundaries and topographical survey data of the site. The accuracy of land registry and the topographical survey differs from the OS base mapping which results in the order limits not aligning with the line work shown on the OS Mapping.
 4. Further information on the Public Rights of Way can be found on Figure 6.5 of the Environmental Statement.

P2	Addition of Temporary Road Closure	RP	14/08/23
P1	Addition of existing PRoW	RP	18/01/23
P0	Submission	RP	18/11/22
REV.	DESCRIPTION	APP.	DATE



PROJECT TITLE
MALLARD PASS SOLAR FARM

DRAWING TITLE
TRAFFIC REGULATION MEASURES PLANS - TEMPORARY ROAD CLOSURES - SHEET 4 OF 13
Infrastructure Planning (Applications: Prescribed Forms and Procedure) Regulations 2009
APFP Regulation: 5(2)(o)

PINS REFERENCE NO
EN010127

ISSUED BY	Oxford	T:	01865 887 050
DATE	18 NOV 2022	DRAWN	GSF
SCALE@A3	1:2,500	CHECKED	CR
STATUS	Planning	APPROVED	RP

DWG. NO 4990-2001-T-071 **REV :P2**

No dimensions are to be scaled from this drawing.
 All dimensions are to be checked on site.
 Area measurements for indicative purposes only.

© LDA Design Consulting Ltd. Quality Assured to BS EN ISO 9001 : 2015
 Sources Ordnance Survey

X:\LDA_4990\2002_MALLARD PASS SOLAR FARM\CAD\1.0 CURRENT\1.0.1 SHEETS\PROWS\4990-2001-T-067-078 + 090-091-P2 - TRAFFIC REGULATION MEASURES PLANS - TEMPORARY ROAD CLOSURES.DWG

X:\LDA_4990\2002_MALLARD PASS SOLAR FARM\CAD\1.0 CURRENT\1.0.1 SHEETS\PROWS\4990-2001-T-067-078 + 090-091-P2 - TRAFFIC REGULATION MEASURES PLANS - TEMPORARY ROAD CLOSURES.DWG



LEGEND

KEY PLAN:

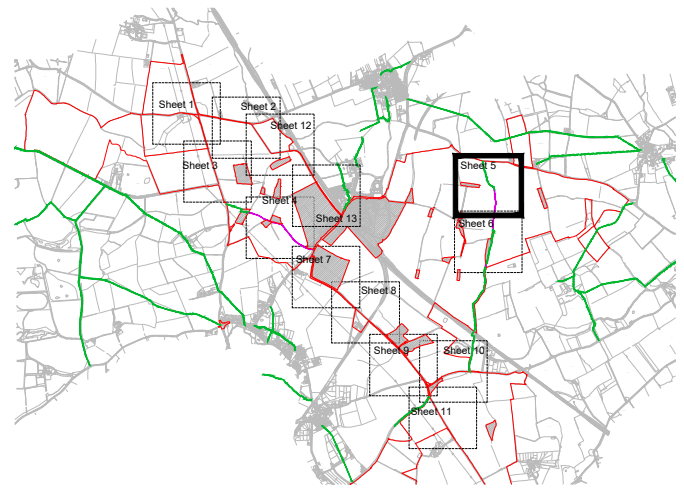

- Order limits
- Areas outside of Order limits
- Proposed Temporary Road Closures
- Proposed Temporary Road Closures (Public Right of Way)
- Existing public right of way

- NOTES:
1. The Traffic Regulation Measures Plans should be read in conjunction with the Development Consent Order and the documents to be certified under it, in particular article 15, and Schedule 6 of the Development Consent Order.
 2. Information relating to the Public Rights of Way and accesses can be found on the rights of way and access plans.
 3. The Order limits has been drawn to the Land Registry boundaries and topographical survey data of the site. The accuracy of land registry and the topographical survey differs from the OS base mapping which results in the order limits not aligning with the line work shown on the OS Mapping.
 4. Further information on the Public Rights of Way can be found on Figure 6.5 of the Environmental Statement.

REV.	DESCRIPTION	APP. DATE
P2	Addition of Temporary Road Closure	RP 14/08/23
P1	Addition of existing PRoW	RP 18/01/23
P0	Submission	RP 18/11/22



PROJECT TITLE
MALLARD PASS SOLAR FARM

DRAWING TITLE
TRAFFIC REGULATION MEASURES PLANS
- TEMPORARY ROAD CLOSURES -
SHEET 5 OF 13
Infrastructure Planning (Applications: Prescribed
Forms and Procedure) Regulations 2009
APFP Regulation: 5(2)(o)

PINS REFERENCE NO
EN010127

ISSUED BY	Oxford	T: 01865 887 050
DATE	18 NOV 2022	DRAWN GSF
SCALE@A3	1:2,500	CHECKED CR
STATUS	Planning	APPROVED RP

DWG. NO 4990-2001-T-072 REV :P2

No dimensions are to be scaled from this drawing.
All dimensions are to be checked on site.
Area measurements for indicative purposes only.

© LDA Design Consulting Ltd. Quality Assured to BS EN ISO 9001 : 2015
Sources Ordnance Survey

X:\LDA_4990\2002_MALLARD PASS SOLAR FARM\CAD\1.0 CURRENT\1.0.1 SHEETS\PROWS\4990-2001-T-067-078 + 090-091-P2 - TRAFFIC REGULATION MEASURES PLANS - TEMPORARY ROAD CLOSURES.DWG

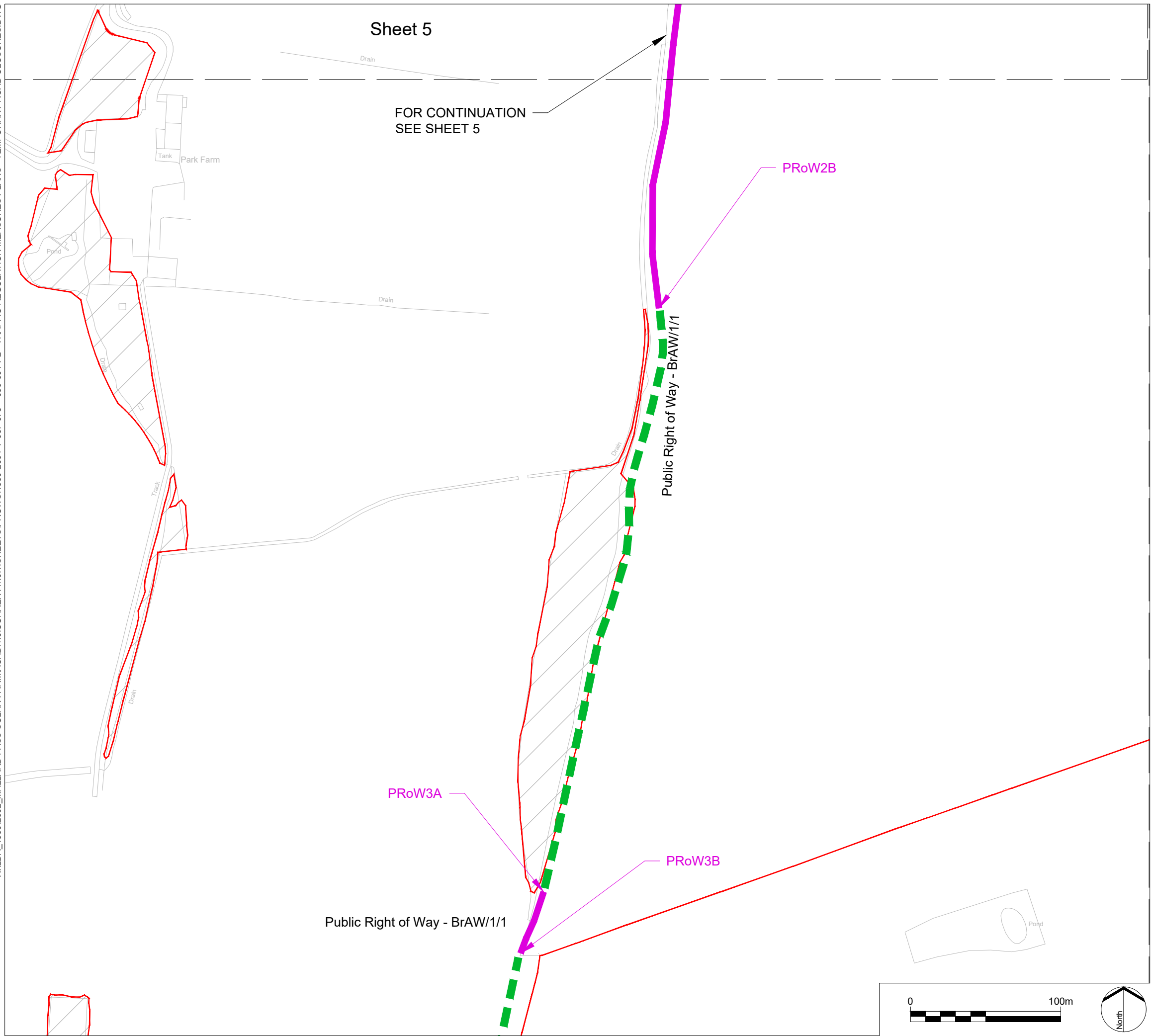

LEGEND

KEY PLAN:

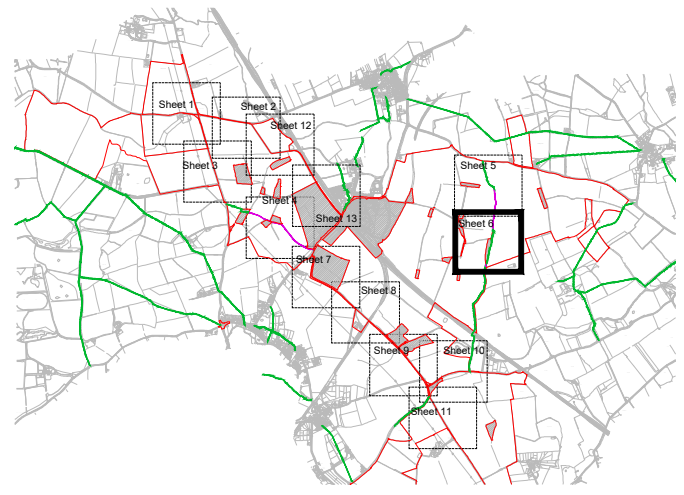

- Order limits
- Areas outside of Order limits
- Proposed Temporary Road Closures
- Proposed Temporary Road Closures (Public Right of Way)
- Existing public right of way

- NOTES:
1. The Traffic Regulation Measures Plans should be read in conjunction with the Development Consent Order and the documents to be certified under it, in particular article 15, and Schedule 6 of the Development Consent Order.
 2. Information relating to the Public Rights of Way and accesses can be found on the rights of way and access plans.
 3. The Order limits has been drawn to the Land Registry boundaries and topographical survey data of the site. The accuracy of land registry and the topographical survey differs from the OS base mapping which results in the order limits not aligning with the line work shown on the OS Mapping.
 4. Further information on the Public Rights of Way can be found on Figure 6.5 of the Environmental Statement.

REV.	DESCRIPTION	APP. DATE
P2	Addition of Temporary Road Closure	RP 14/08/23
P1	Addition of existing PRoW	RP 18/01/23
P0	Submission	RP 18/11/22



PROJECT TITLE
MALLARD PASS SOLAR FARM

DRAWING TITLE
TRAFFIC REGULATION MEASURES PLANS - TEMPORARY ROAD CLOSURES - SHEET 6 OF 13
 Infrastructure Planning (Applications: Prescribed Forms and Procedure) Regulations 2009
 APFP Regulation: 5(2)(o)

PINS REFERENCE NO
EN010127

ISSUED BY	Oxford	T: 01865 887 050
DATE	18 NOV 2022	DRAWN GSF
SCALE@A3	1:2,500	CHECKED CR
STATUS	Planning	APPROVED RP

DWG. NO 4990-2001-T-073 **REV :P2**

No dimensions are to be scaled from this drawing.
 All dimensions are to be checked on site.
 Area measurements for indicative purposes only.

© LDA Design Consulting Ltd. Quality Assured to BS EN ISO 9001 : 2015
 Sources Ordnance Survey

X:\LDA_4990\2002_MALLARD PASS SOLAR FARM\CAD\1.0 CURRENT\1.0.1 SHEETS\PROWS\4990-2001-T-067-078 + 090-091-P2 - TRAFFIC REGULATION MEASURES PLANS - TEMPORARY ROAD CLOSURES.DWG

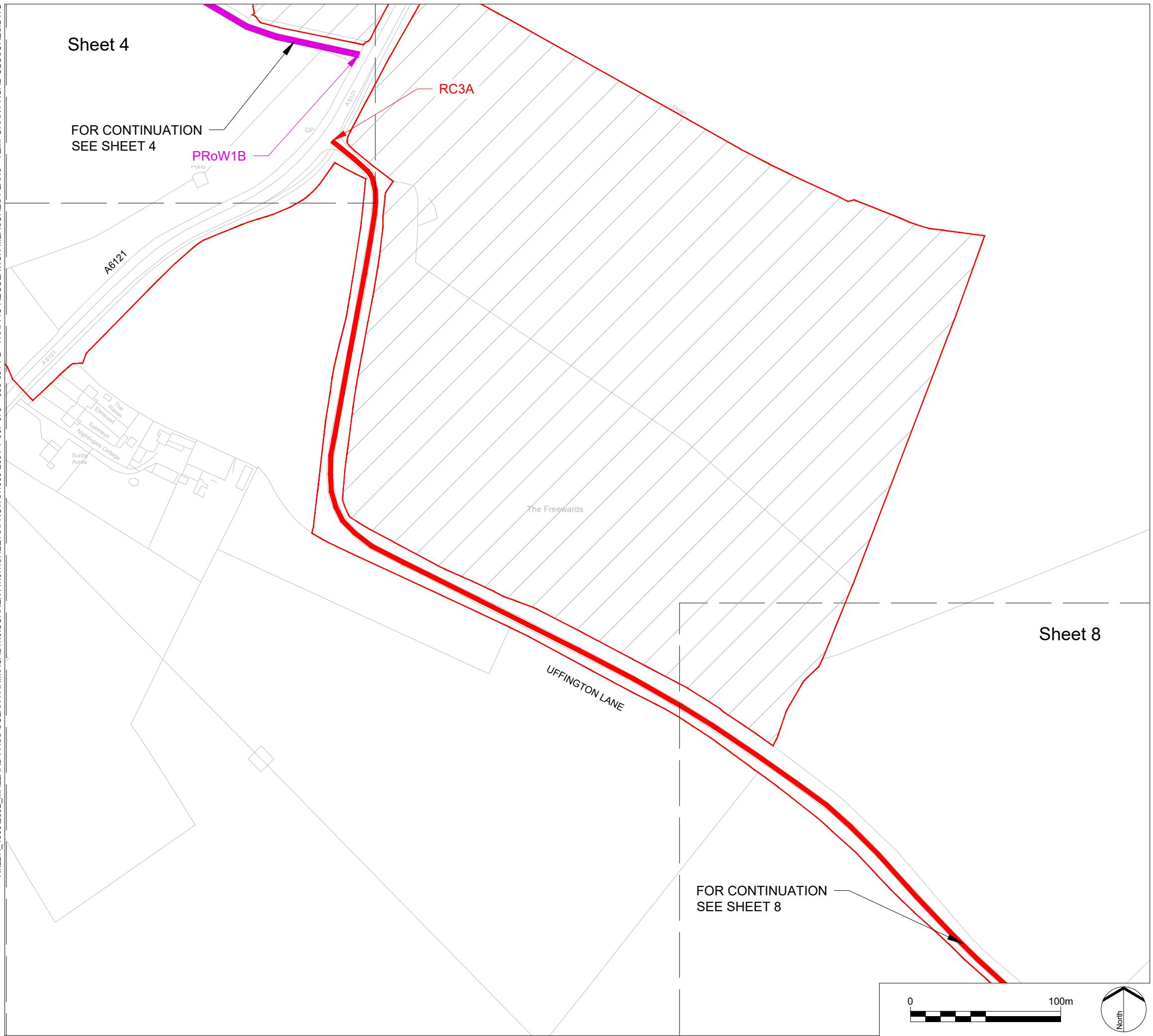

LEGEND

KEY PLAN:

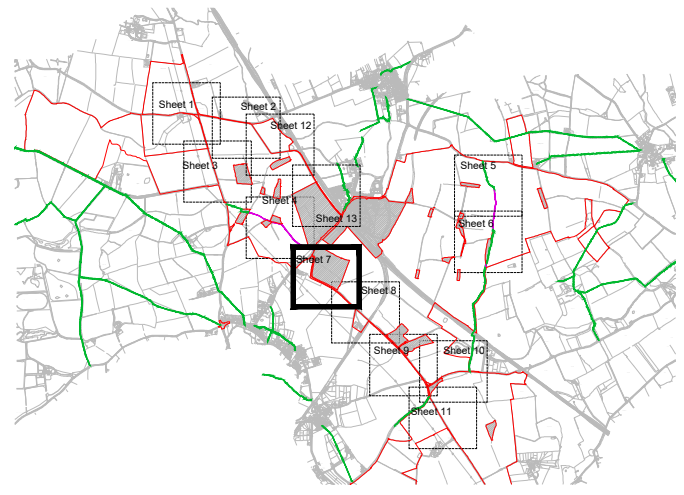

- Order limits
- Areas outside of Order limits
- Proposed Temporary Road Closures
- Proposed Temporary Road Closures (Public Right of Way)
- Existing public right of way

- NOTES:
1. The Traffic Regulation Measures Plans should be read in conjunction with the Development Consent Order and the documents to be certified under it, in particular article 15, and Schedule 9 of the Development Consent Order.
 2. Information relating to the Public Rights of Way and accesses can be found on the rights of way and access plans.
 3. The Order limits has been drawn to the Land Registry boundaries and topographical survey data of the site. The accuracy of land registry and the topographical survey differs from the OS base mapping which results in the order limits not aligning with the line work shown on the OS Mapping.
 4. Further information on the Public Rights of Way can be found on Figure 6.5 of the Environmental Statement.

P2	Addition of Temporary Road Closure	RP	14/08/23
P1	Addition of existing PRoW	RP	18/01/23
P0	Submission	RP	18/11/22
REV.	DESCRIPTION	APP.	DATE



PROJECT TITLE
MALLARD PASS SOLAR FARM

DRAWING TITLE
**TRAFFIC REGULATION MEASURES PLANS
- TEMPORARY ROAD CLOSURES -
SHEET 7 OF 13**
Infrastructure Planning (Applications: Prescribed
Forms and Procedure) Regulations 2009
APFP Regulation: 5(2)(o)

PINS REFERENCE NO
EN010127

ISSUED BY	Oxford	T:	01865 887 050
DATE	18 NOV 2022	DRAWN	GSF
SCALE@A3	1:2,500	CHECKED	CR
STATUS	Planning	APPROVED	RP

DWG. NO 4990-2001-T-074 **REV :P2**

No dimensions are to be scaled from this drawing.
All dimensions are to be checked on site.
Area measurements for indicative purposes only.

© LDA Design Consulting Ltd. Quality Assured to BS EN ISO 9001 : 2015

Sources Ordnance Survey

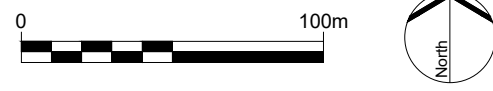

X:\LDA_4990\2002_MALLARD PASS SOLAR FARM\CAD\1.0 CURRENT\1.0.1 SHEETS\PROWS\4990-2001-T-067-078 + 090-091-P2 - TRAFFIC REGULATION MEASURES PLANS - TEMPORARY ROAD CLOSURES.DWG

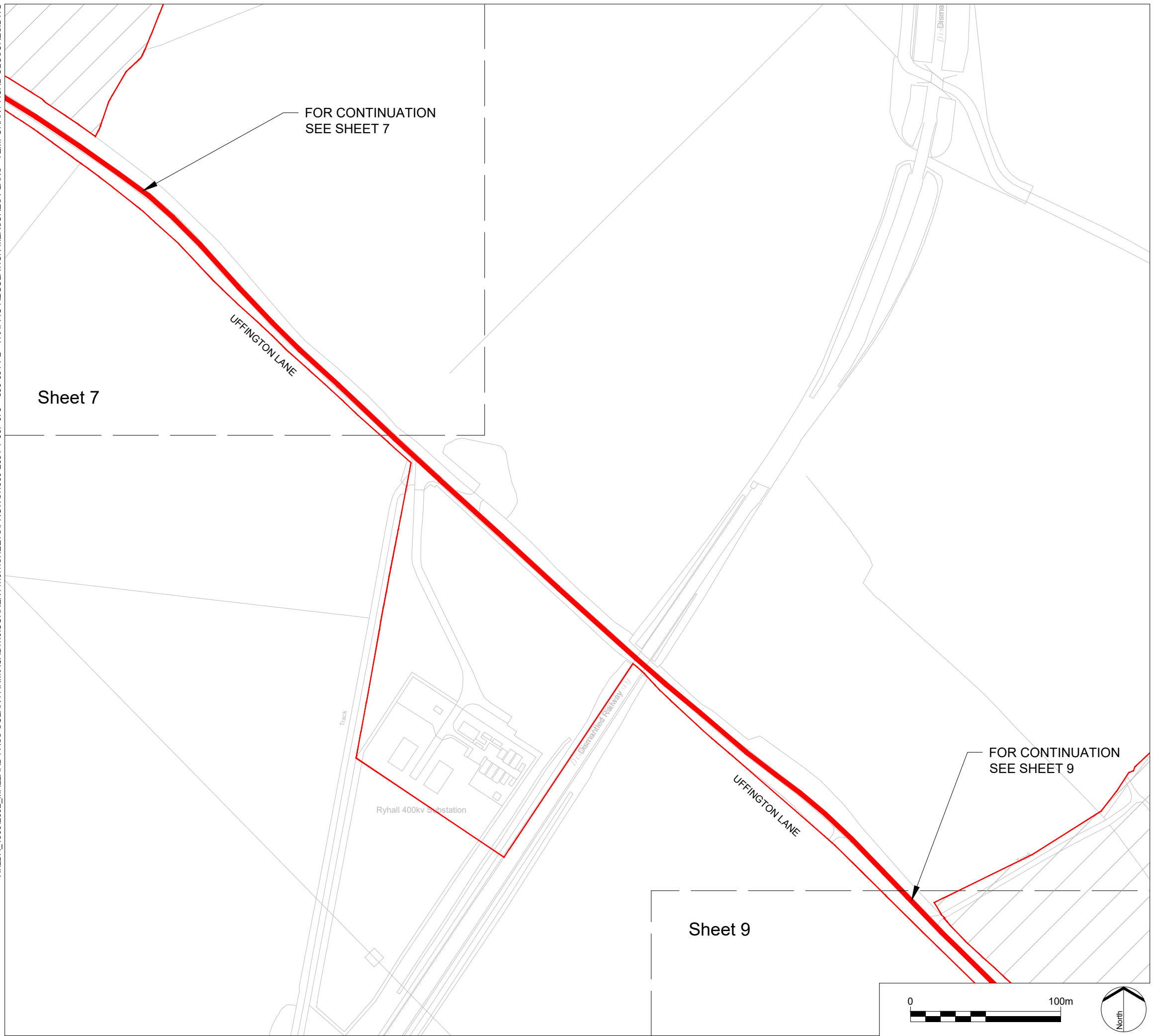

LEGEND

KEY PLAN:

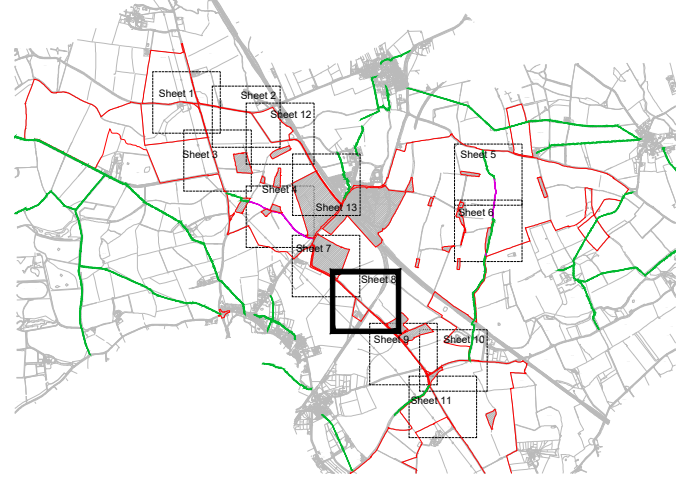

- Order limits
- Areas outside of Order limits
- Proposed Temporary Road Closures
- Proposed Temporary Road Closures (Public Right of Way)
- Existing public right of way

- NOTES:
1. The Traffic Regulation Measures Plans should be read in conjunction with the Development Consent Order and the documents to be certified under it, in particular article 15, and Schedule 9 of the Development Consent Order.
 2. Information relating to the Public Rights of Way and accesses can be found on the rights of way and access plans.
 3. The Order limits has been drawn to the Land Registry boundaries and topographical survey data of the site. The accuracy of land registry and the topographical survey differs from the OS base mapping which results in the order limits not aligning with the line work shown on the OS Mapping.
 4. Further information on the Public Rights of Way can be found on Figure 6.5 of the Environmental Statement.

P2	Addition of Temporary Road Closure	RP	14/08/23
P1	Addition of existing PRoW	RP	18/01/23
P0	Submission	RP	18/11/22
REV.	DESCRIPTION	APP.	DATE



PROJECT TITLE
MALLARD PASS SOLAR FARM

DRAWING TITLE
TRAFFIC REGULATION MEASURES PLANS - TEMPORARY ROAD CLOSURES - SHEET 8 OF 13
Infrastructure Planning (Applications: Prescribed Forms and Procedure) Regulations 2009
APFP Regulation: 5(2)(o)

PINS REFERENCE NO
EN010127

ISSUED BY	Oxford	T:	01865 887 050
DATE	18 NOV 2022	DRAWN	GSF
SCALE@A3	1:2,500	CHECKED	CR
STATUS	Planning	APPROVED	RP

DWG. NO 4990-2001-T-075 **REV :P2**

No dimensions are to be scaled from this drawing.
All dimensions are to be checked on site.
Area measurements for indicative purposes only.

© LDA Design Consulting Ltd. Quality Assured to BS EN ISO 9001 : 2015
Sources Ordnance Survey

X:\LDA_4990\2002_MALLARD PASS SOLAR FARM\CAD\1.0_CURRENT\1.0.1_SHEETS\PROWS\4990-2001-T-067-078 + 090-091-P2 - TRAFFIC REGULATION MEASURES PLANS - TEMPORARY ROAD CLOSURES.DWG

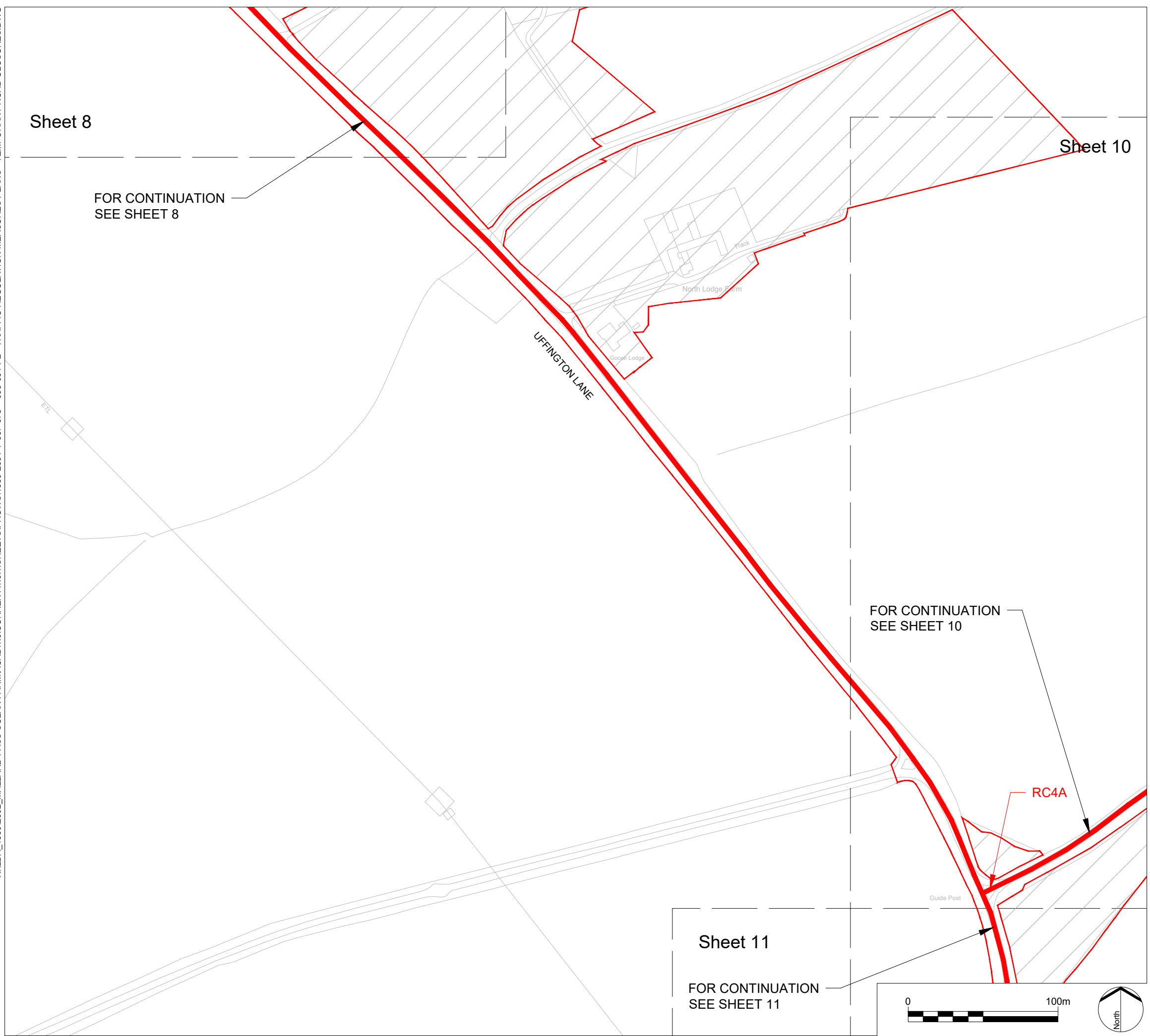

LEGEND

KEY PLAN:

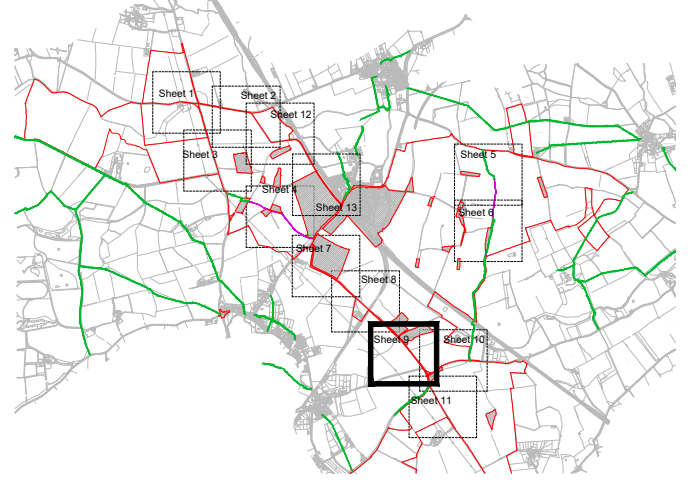

- Order limits
- Areas outside of Order limits
- Proposed Temporary Road Closures
- Proposed Temporary Road Closures (Public Right of Way)
- Existing public right of way

- NOTES:
1. The Traffic Regulation Measures Plans should be read in conjunction with the Development Consent Order and the documents to be certified under it, in particular article 15, and Schedule 6 of the Development Consent Order.
 2. Information relating to the Public Rights of Way and accesses can be found on the rights of way and access plans.
 3. The Order limits has been drawn to the Land Registry boundaries and topographical survey data of the site. The accuracy of land registry and the topographical survey differs from the OS base mapping which results in the order limits not aligning with the line work shown on the OS Mapping.
 4. Further information on the Public Rights of Way can be found on Figure 6.5 of the Environmental Statement.

P2	Addition of Temporary Road Closure	RP	14/08/23
P1	Addition of existing PRoW	RP	18/01/23
P0	Submission	RP	18/11/22
REV.	DESCRIPTION	APP.	DATE



PROJECT TITLE
MALLARD PASS SOLAR FARM

DRAWING TITLE
TRAFFIC REGULATION MEASURES PLANS - TEMPORARY ROAD CLOSURES - SHEET 9 OF 13
 Infrastructure Planning (Applications: Prescribed Forms and Procedure) Regulations 2009
 APFP Regulation: 5(2)(o)

PINS REFERENCE NO
EN010127

ISSUED BY	Oxford	T:	01865 887 050
DATE	18 NOV 2022	DRAWN	GSF
SCALE@A3	1:2,500	CHECKED	CR
STATUS	Planning	APPROVED	RP

DWG. NO 4990-2001-T-076 **REV :P2**

No dimensions are to be scaled from this drawing.
 All dimensions are to be checked on site.
 Area measurements for indicative purposes only.

© LDA Design Consulting Ltd. Quality Assured to BS EN ISO 9001 : 2015
 Sources Ordnance Survey

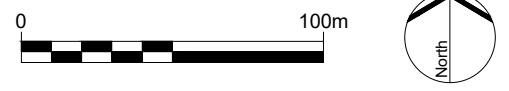

X:\LDA_4990\2002_MALLARD PASS SOLAR FARM\CAD\1.0 CURRENT\1.0.1 SHEETS\PROWS\4990-2001-T-067-078 + 090-091-P2 - TRAFFIC REGULATION MEASURES PLANS - TEMPORARY ROAD CLOSURES.DWG

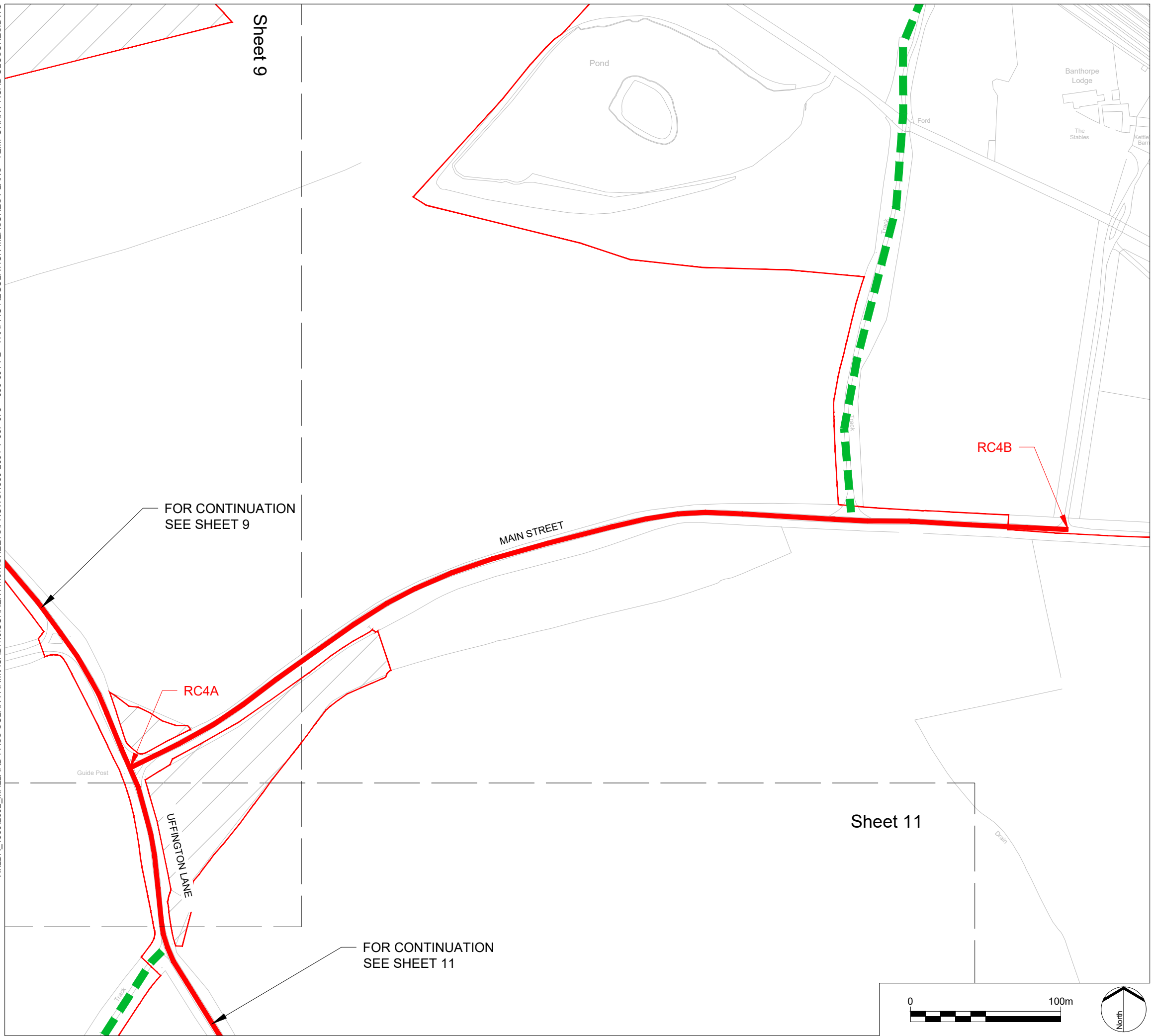

LEGEND

KEY PLAN:

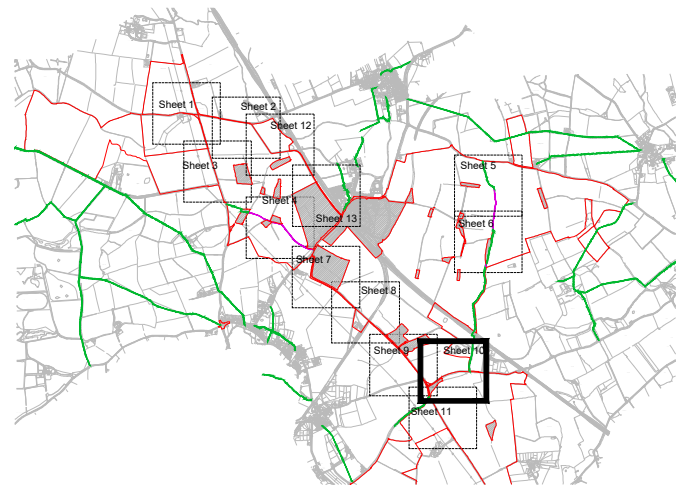

- Order limits
- Areas outside of Order limits
- Proposed Temporary Road Closures
- Proposed Temporary Road Closures (Public Right of Way)
- Existing public right of way

- NOTES:
1. The Traffic Regulation Measures Plans should be read in conjunction with the Development Consent Order and the documents to be certified under it, in particular article 15, and Schedule 6 of the Development Consent Order.
 2. Information relating to the Public Rights of Way and accesses can be found on the rights of way and access plans.
 3. The Order limits has been drawn to the Land Registry boundaries and topographical survey data of the site. The accuracy of land registry and the topographical survey differs from the OS base mapping which results in the order limits not aligning with the line work shown on the OS Mapping.
 4. Further information on the Public Rights of Way can be found on Figure 6.5 of the Environmental Statement.

REV.	DESCRIPTION	APP. DATE
P2	Addition of Temporary Road Closure	RP 14/08/23
P1	Addition of existing PRoW	RP 18/01/23
P0	Submission	RP 18/11/22



PROJECT TITLE
MALLARD PASS SOLAR FARM

DRAWING TITLE
TRAFFIC REGULATION MEASURES PLANS - TEMPORARY ROAD CLOSURES - SHEET 10 OF 13
 Infrastructure Planning (Applications: Prescribed Forms and Procedure) Regulations 2009
 APFP Regulation: 5(2)(o)

PINS REFERENCE NO
EN010127

ISSUED BY	Oxford	T: 01865 887 050
DATE	18 NOV 2022	DRAWN GSF
SCALE@A3	1:2,500	CHECKED CR
STATUS	Planning	APPROVED RP

DWG. NO 4990-2001-T-077 REV :P2

No dimensions are to be scaled from this drawing.
 All dimensions are to be checked on site.
 Area measurements for indicative purposes only.

© LDA Design Consulting Ltd. Quality Assured to BS EN ISO 9001 : 2015
 Sources Ordnance Survey

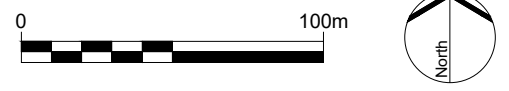

X:\LDA_4990\2002_MALLARD PASS SOLAR FARM\CAD\1.0 CURRENT\1.0.1 SHEETS\PROWS\4990-2001-T-067-078 + 090-091-P2 - TRAFFIC REGULATION MEASURES PLANS - TEMPORARY ROAD CLOSURES.DWG

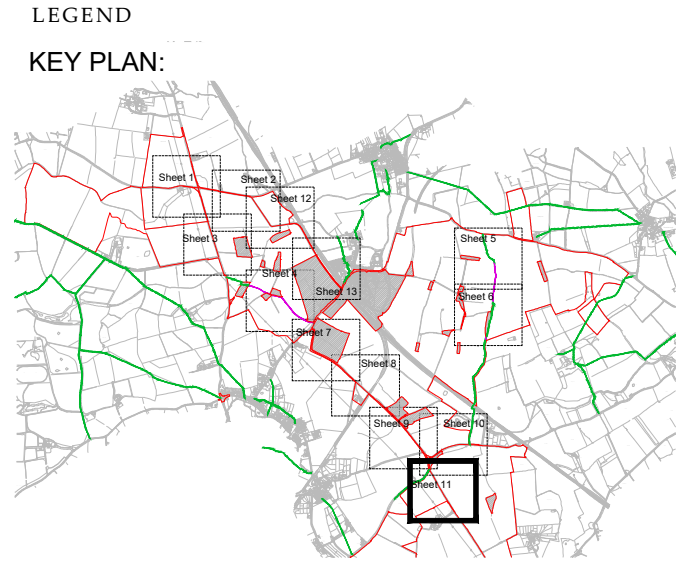
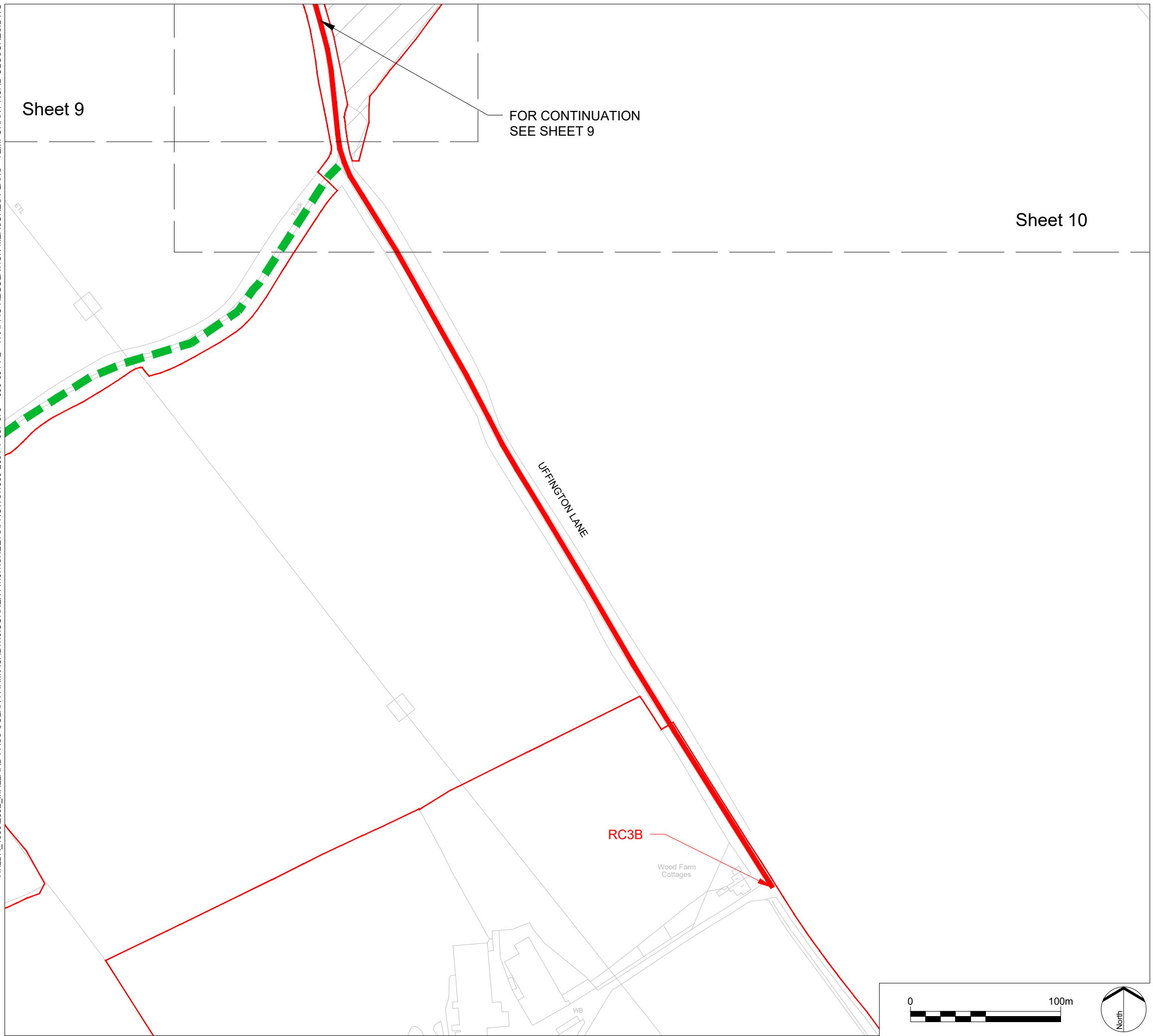

- LEGEND**
- Order limits
 - Areas outside of Order limits
 - Proposed Temporary Road Closures
 - Proposed Temporary Road Closures (Public Right of Way)
 - Existing public right of way

- NOTES:**
1. The Traffic Regulation Measures Plans should be read in conjunction with the Development Consent Order and the documents to be certified under it, in particular article 15, and Schedule 6 of the Development Consent Order.
 2. Information relating to the Public Rights of Way and accesses can be found on the rights of way and access plans.
 3. The Order limits has been drawn to the Land Registry boundaries and topographical survey data of the site. The accuracy of land registry and the topographical survey differs from the OS base mapping which results in the order limits not aligning with the line work shown on the OS Mapping.
 4. Further information on the Public Rights of Way can be found on Figure 6.5 of the Environmental Statement.

P2	Addition of Temporary Road Closure	RP	14/08/23
P1	Addition of existing PRoW	RP	18/01/23
P0	Submission	RP	18/11/22
REV.	DESCRIPTION	APP.	DATE



PROJECT TITLE
MALLARD PASS SOLAR FARM

DRAWING TITLE
TRAFFIC REGULATION MEASURES PLANS - TEMPORARY ROAD CLOSURES - SHEET 11 OF 13
Infrastructure Planning (Applications: Prescribed Forms and Procedure) Regulations 2009
APFP Regulation: 5(2)(o)

PINS REFERENCE NO
EN010127

ISSUED BY	Oxford	T:	01865 887 050
DATE	18 NOV 2022	DRAWN	GSF
SCALE@A3	1:2,500	CHECKED	CR
STATUS	Planning	APPROVED	RP

DWG. NO 4990-2001-T-078 **REV :P2**

No dimensions are to be scaled from this drawing.
 All dimensions are to be checked on site.
 Area measurements for indicative purposes only.

© LDA Design Consulting Ltd. Quality Assured to BS EN ISO 9001 : 2015
 Sources Ordnance Survey

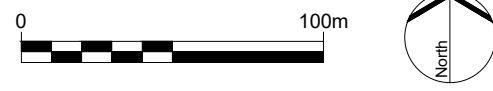

X:\LDA_4990\2002_MALLARD PASS SOLAR FARM\CAD\1.0 CURRENT\1.0.1 SHEETS\PROWS\4990-2001-T-067-078 + 090-091-P2 - TRAFFIC REGULATION MEASURES PLANS - TEMPORARY ROAD CLOSURES.DWG

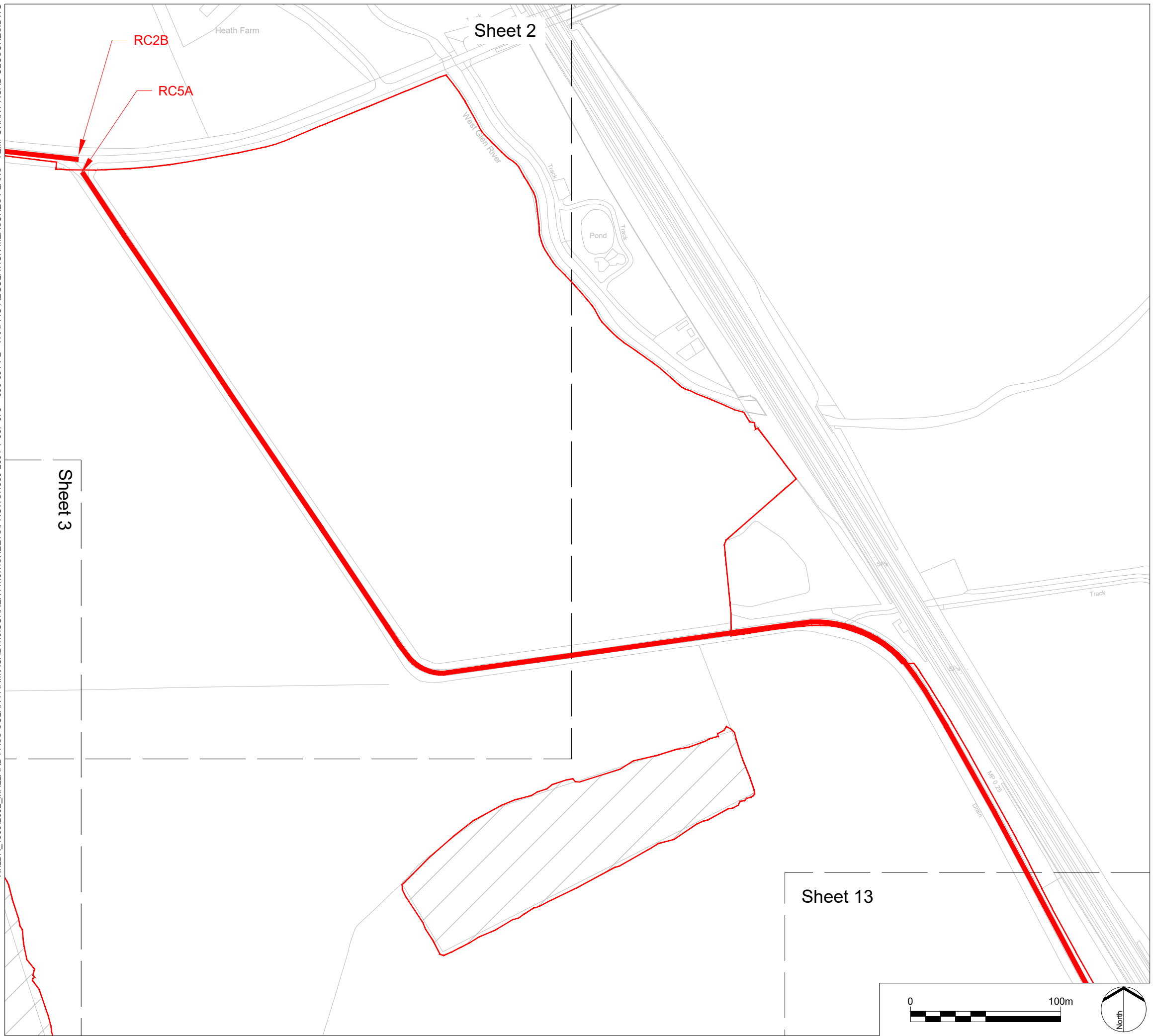

LEGEND

KEY PLAN:

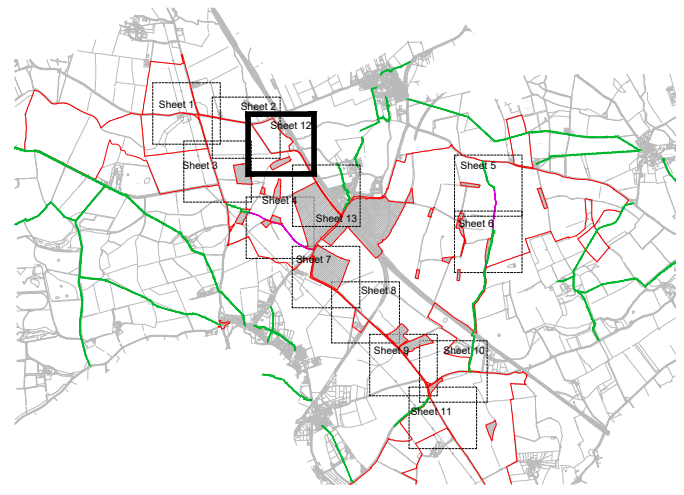

- Order limits
- Areas outside of Order limits
- Proposed Temporary Road Closures
- Proposed Temporary Road Closures (Public Right of Way)
- Existing public right of way

- NOTES:
1. The Traffic Regulation Measures Plans should be read in conjunction with the Development Consent Order and the documents to be certified under it, in particular article 15, and Schedule 6 of the Development Consent Order.
 2. Information relating to the Public Rights of Way and accesses can be found on the rights of way and access plans.
 3. The Order limits has been drawn to the Land Registry boundaries and topographical survey data of the site. The accuracy of land registry and the topographical survey differs from the OS base mapping which results in the order limits not aligning with the line work shown on the OS Mapping.
 4. Further information on the Public Rights of Way can be found on Figure 6.5 of the Environmental Statement.

P0 Submission
 REV. DESCRIPTION

RP 14/08/23
 APP. DATE



PROJECT TITLE
MALLARD PASS SOLAR FARM

DRAWING TITLE
TRAFFIC REGULATION MEASURES PLANS - TEMPORARY ROAD CLOSURES - SHEET 12 OF 13
 Infrastructure Planning (Applications: Prescribed Forms and Procedure) Regulations 2009
 APFP Regulation: 5(2)(o)

PINS REFERENCE NO
EN010127

ISSUED BY	Oxford	T: 01865 887 050
DATE	14 AUG 2023	DRAWN GSF
SCALE@A3	1:2,500	CHECKED CR
STATUS	Planning	APPROVED RP

DWG. NO 4990-2001-T-090 REV :P0

No dimensions are to be scaled from this drawing.
 All dimensions are to be checked on site.
 Area measurements for indicative purposes only.

© LDA Design Consulting Ltd. Quality Assured to BS EN ISO 9001 : 2015

Sources Ordnance Survey

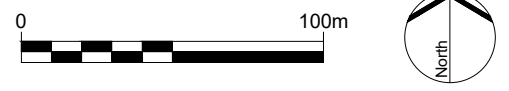

X:\LDA_4990\2002_MALLARD PASS SOLAR FARM\CAD\1.0 CURRENT\1.0.1 SHEETS\PROWS\4990-2001-T-067-078 + 090-091-IP2 - TRAFFIC REGULATION MEASURES PLANS - TEMPORARY ROAD CLOSURES.DWG

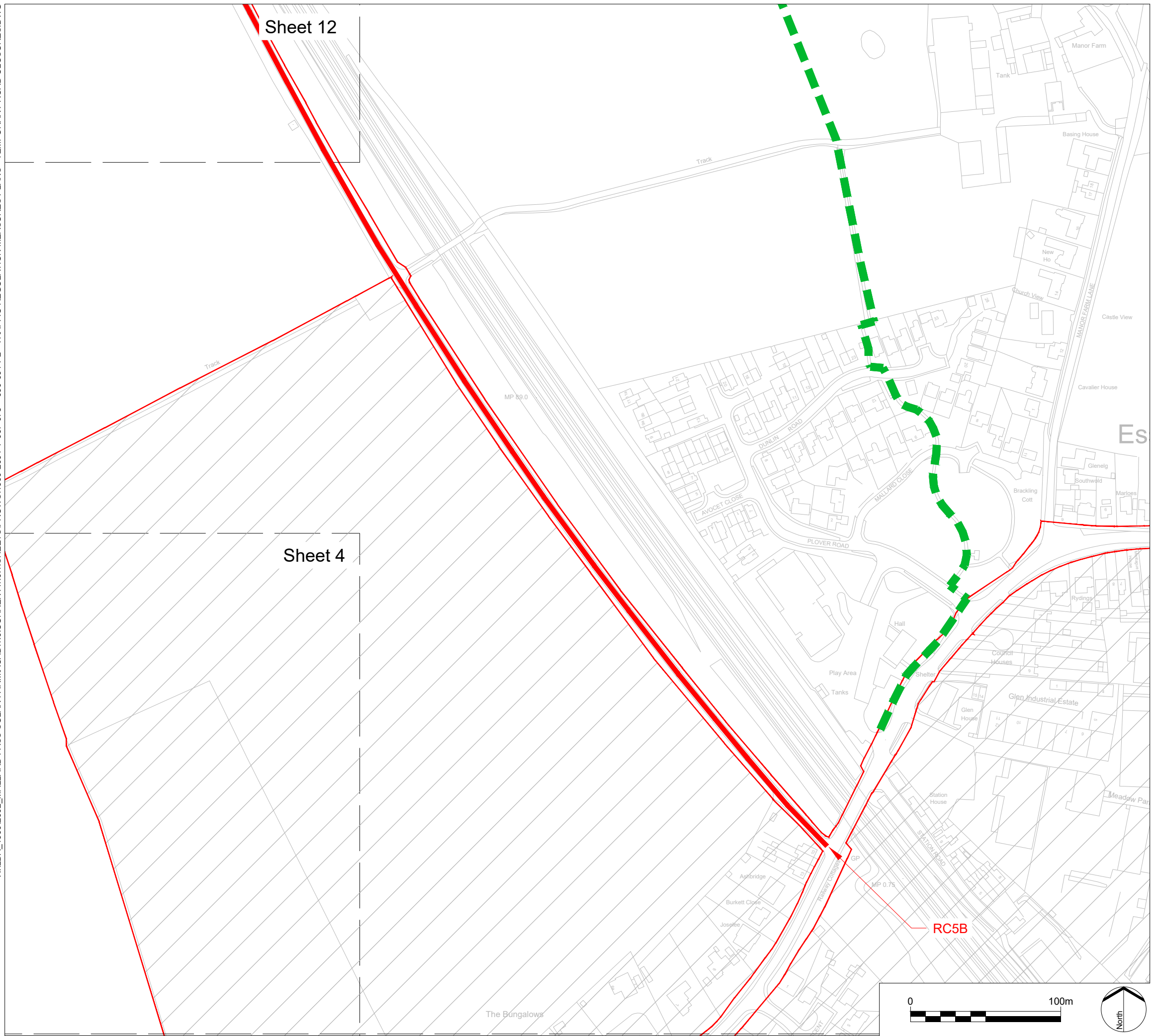

Sheet 12

Sheet 4

LEGEND

KEY PLAN:

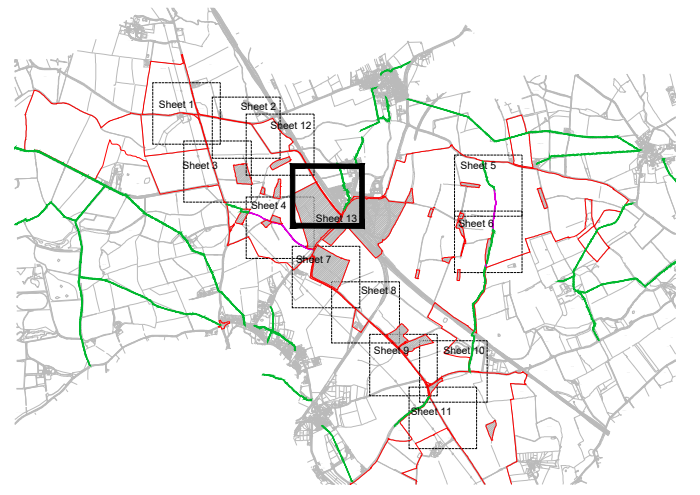

- Order limits
- Areas outside of Order limits
- Proposed Temporary Road Closures
- Proposed Temporary Road Closures (Public Right of Way)
- Existing public right of way

- NOTES:
1. The Traffic Regulation Measures Plans should be read in conjunction with the Development Consent Order and the documents to be certified under it, in particular article 15, and Schedule 9 of the Development Consent Order.
 2. Information relating to the Public Rights of Way and accesses can be found on the rights of way and access plans.
 3. The Order limits has been drawn to the Land Registry boundaries and topographical survey data of the site. The accuracy of land registry and the topographical survey differs from the OS base mapping which results in the order limits not aligning with the line work shown on the OS Mapping.
 4. Further information on the Public Rights of Way can be found on Figure 6.5 of the Environmental Statement.

P0 Submission
REV. DESCRIPTION

RP 14/08/23
APP. DATE



PROJECT TITLE
MALLARD PASS SOLAR FARM

DRAWING TITLE
TRAFFIC REGULATION MEASURES PLANS - TEMPORARY ROAD CLOSURES - SHEET 13 OF 13
Infrastructure Planning (Applications: Prescribed Forms and Procedure) Regulations 2009
APFP Regulation: 5(2)(o)

PINS REFERENCE NO
EN010127

ISSUED BY	Oxford	T: 01865 887 050
DATE	14 AUG 2023	DRAWN GSF
SCALE@A3	1:2,500	CHECKED CR
STATUS	Planning	APPROVED RP

DWG. NO 4990-2001-T-097 **REV :P0**

No dimensions are to be scaled from this drawing.
All dimensions are to be checked on site.
Area measurements for indicative purposes only.

© LDA Design Consulting Ltd. Quality Assured to BS EN ISO 9001 : 2015
Sources Ordnance Survey

